

# Premium Booth 3mW x 5mD One side open

SD-A-15  
3mW x 5mD x 3.5mH

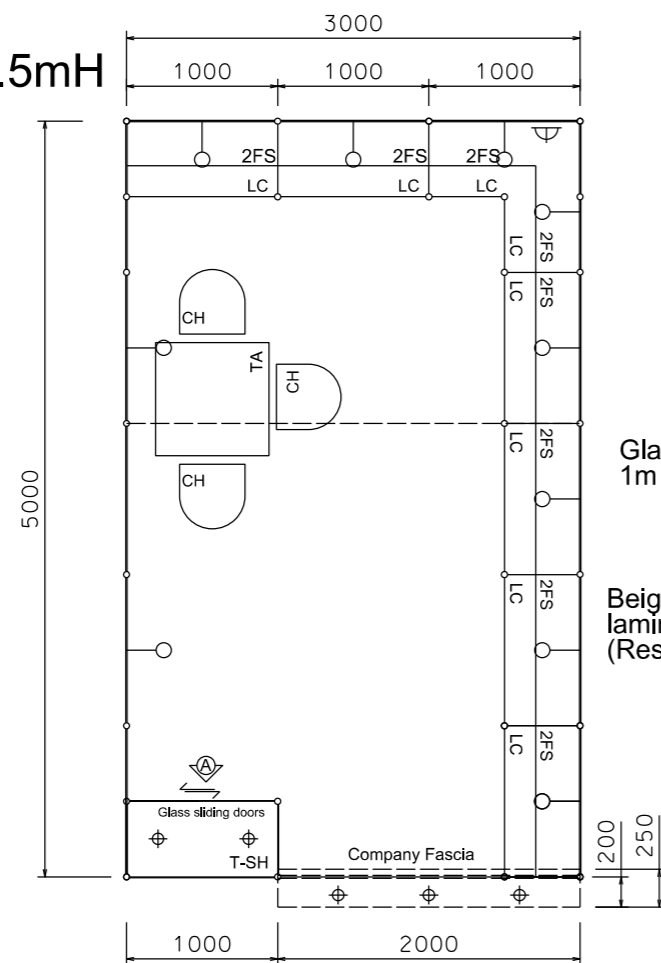

PLAN

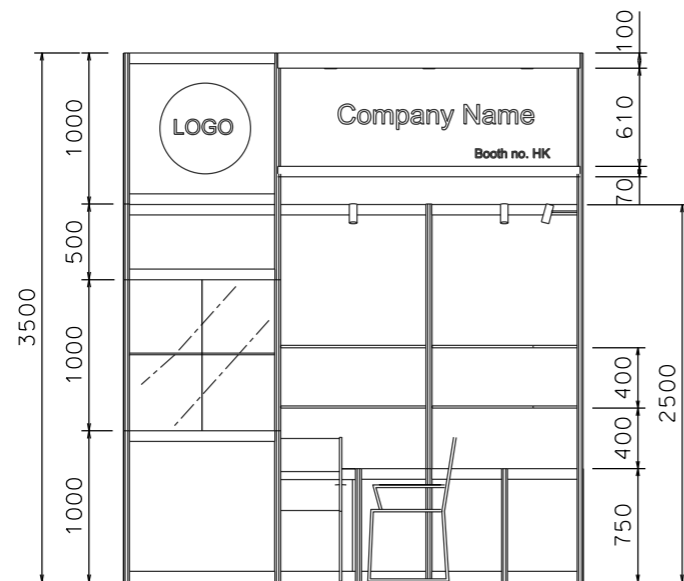

FRONT ELEVATION

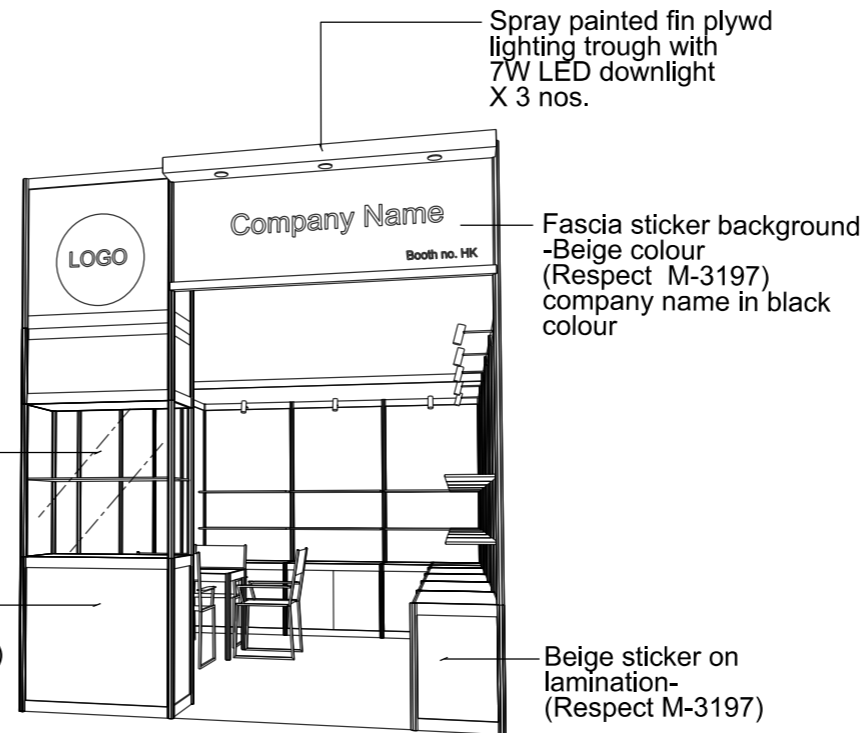

PERSPECTIVE N.T.S



COLOUR PERSPECTIVE N.T.S

BOOTH SPECIFICATION		QTY
	Tall showcase in beige sticker lamination, 1 layer of glass shelf, 2x 7W LED downlights	1
	Lockable cabinet in beige sticker lamination (1mL x 0.5mD x 0.75mH)	7.5
	Wooden shelf (flat) (1mL x 0.3mD)	16
	Square meeting table (0.7m X0.7m x 0.75mH)	1
	Black leather chair	3
	13W LED Lamp Longarmed Spotlight (yellow)	10
	7W LED light (for fascia)	3
	500w Square pin power socket	1
	Company Logo	1

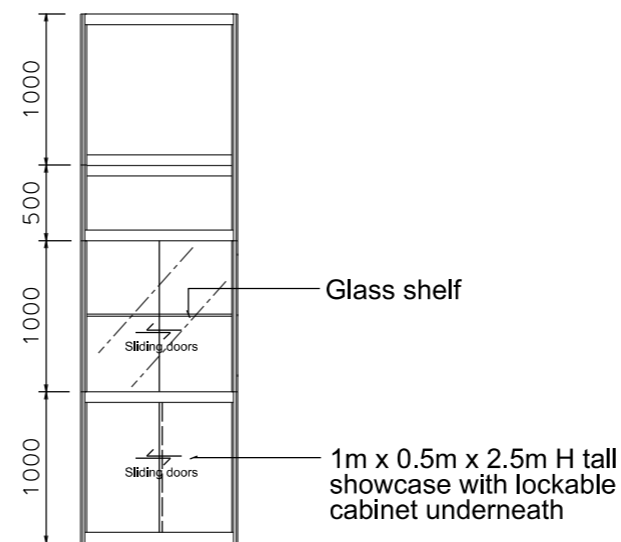

VIEW A

FILE PATH - L:\Local Fair Premium Booth 2011\SD-Layouts\SD-A layout\SD-A-Layout-New.dgn



NOTES UNLESS OTHERWISE SPECIFIED ALL DIMENSIONS ARE IN MM.

.....  
.....  
.....

REVISION  
26-11-08  
31-12-2008  
15-01-2009  
09-02-2009  
12-05-2009  
18-05-2009  
15-07-2009  
08-01-2019

DATE: 08-01-2019  
SCALE: 1 : 50 (A3)  
DRAWN BY: ..  
CHECKED BY: .....

TITLE  
Premium Booth SD-A-15

PROJECT  
PREMIUM BOOTH 3m x 5m  
DATE: XXXXXXXX

SHEET  
SD-A03