

Premium Booth 4mW x 3mD Left Corner Booth

SD-D-12-L-Cnr
4mW x 3mD x 3.5mH

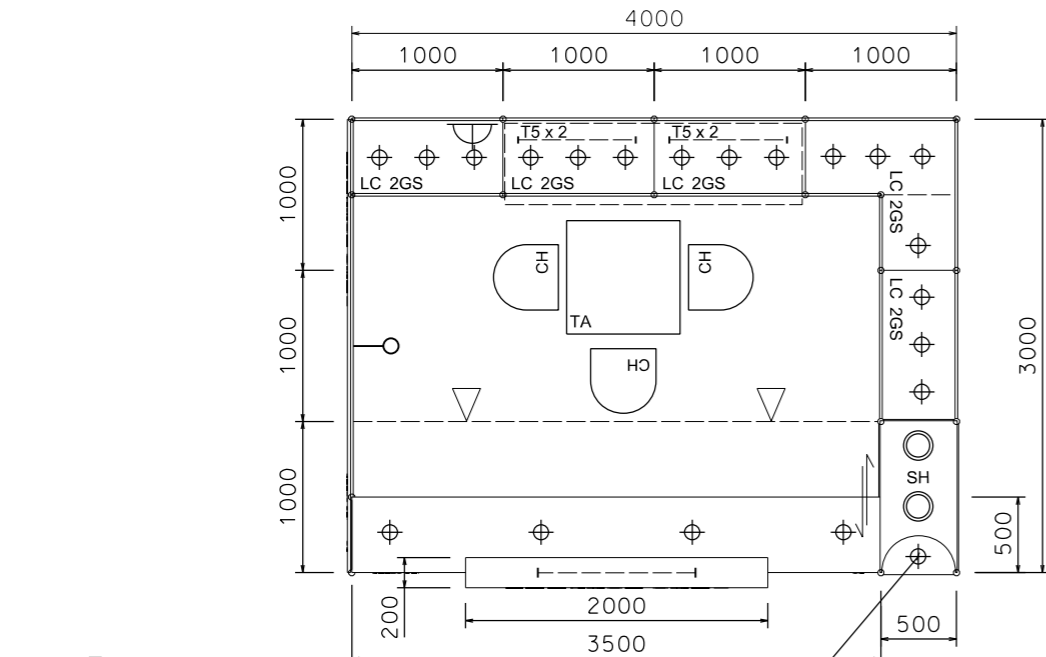

COLOUR PERSPECTIVE N.T.S



Plan

1 x 50w halogen uplight for upper part,

1 x 50w halogen downlight for lower part

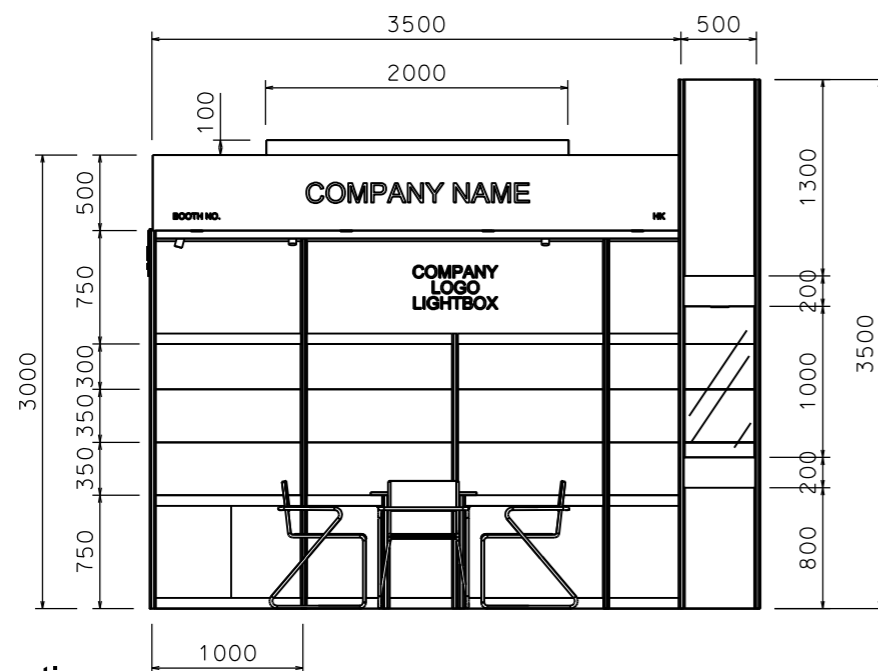

Top Elevation

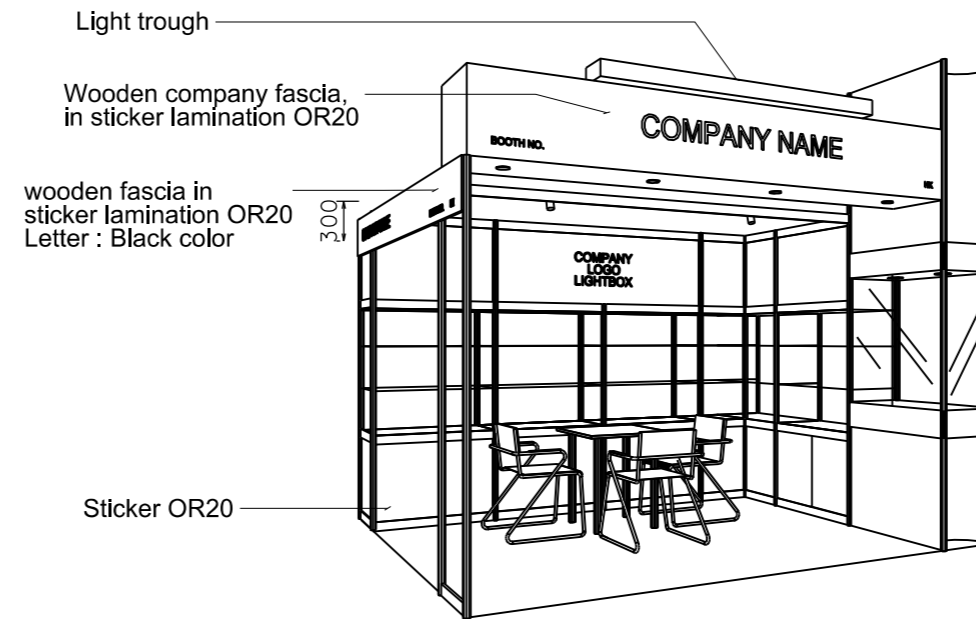

PERSPECTIVE N.T.S

BOOTH SPECIFICATION		QTY
	Front glass showcase in light orange sticker lamination with glass sliding door. 2 x (100W) recess downlight & 2 x (50w) uplight and downlight	1
	Company logo lightbox w/ 4 x T5 tube (2mL)	1
	Tall showcase in light orange sticker lamination (without glass door), w/ 2 layers glass shelf, 3x50w halogen downlight, cabinet underneath (1mW x 0.5mD x 2.5mH)	5.5
	Square meeting table (0.7m X0.7m x 0.75mH)	1
	Black leather chair	3
	Longarmed spotlight w/23 watt energy saving lamp (yellow)	1
	Spotlight w/ 23w energy saving lamp (Yellow)	2
	T5 tube inside light trough	1
	500w Square pin power socket	1
	50w halogen downlight (under fascia)	4

FILE PATH - L:\Local Fair Premium Booth 2011\SD-Layouts\SD-D layout-update.dgn



NOTES UNLESS OTHERWISE SPECIFIED ALL DIMENSIONS ARE IN MM.

.....
.....
.....

.....
.....
.....

REVISION
01/04/2011
01-04-2014

DATE: 01-04-2014
SCALE: 1 : 50 (A3)
DRAWN BY: ..
CHECKED BY:

TITLE
Premium Booth
SD-D-12-L-Cnr
4x3

PROJECT
PREMIUM BOOTH
DATE: XXXXXXXX

SHEET
SD-D03a